

## SHOP / STORAGE SPACE FOR LEASE

1.5+- MILES NORTH OF WADE HAMPTON BLVD (HWY 29)

1729 LOCUST HILL ROAD (HWY 290), GREER

- 12'X14' DRIVE-IN DOOR
- PERSONAL DOOR
- RESTROOM
- 16' CEILING

800+- SF

DEVELOPMENT HAS  
CODED ENTRY GATE

**AVAILABLE APRIL 1ST: UNIT C3**



WIRELESS INTERNET: \$40/MO  
TRAILER PARKING AVAILABLE:  
30' LONG SPOTS: \$65/MO  
40' LONG SPOTS: \$95/MO

- NOT HEATED OR COOLED
- OCCUPANCY PERMIT REQUIRED BY GREENVILLE COUNTY
- UNZONED IN GREENVILLE COUNTY
- TAX MAP T009.03-01-018.01
- PUBLIC WATER / SEPTIC

**LEASE RATE: \$775/MONTH**  
TENANT PAYS FOR POWER

FOR MORE INFORMATION CONTACT  
CHUCK LANGSTON AT 864-230-4302  
clangston@langston-black.com

**Langston Black**  
REAL ESTATE, INC.

P.O. BOX 2167  
GREER, S.C. 29652  
BUS: 864-848-9070

423

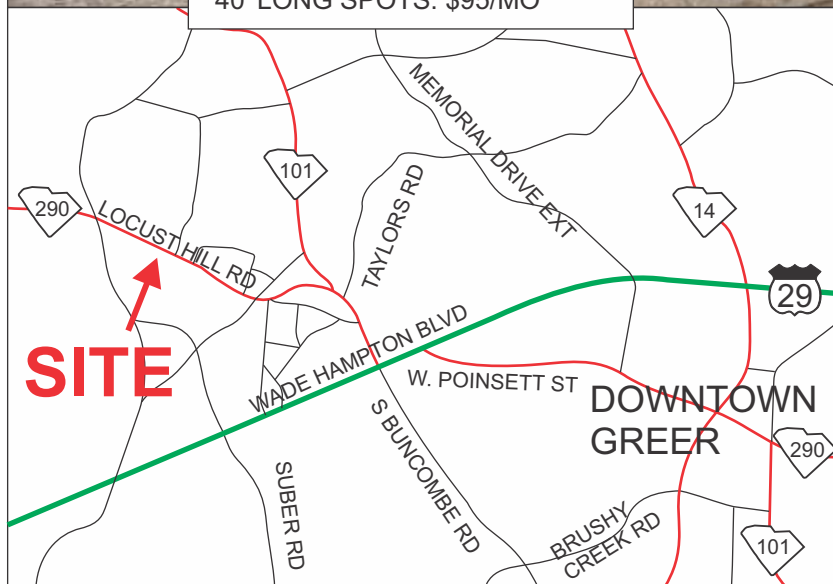

[www.langston-black.com](http://www.langston-black.com)

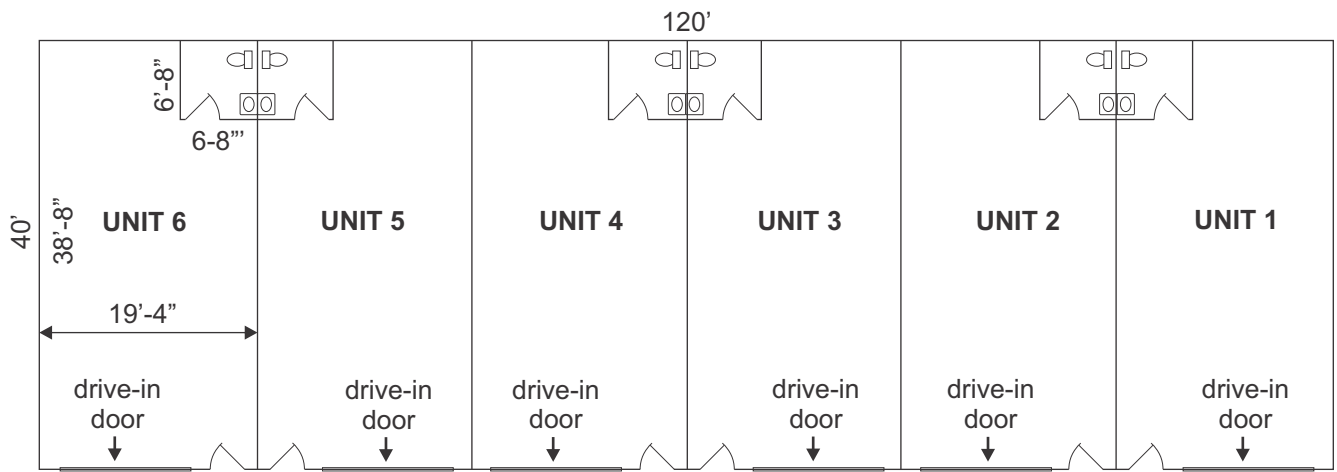

All bays have 16' high ceilings

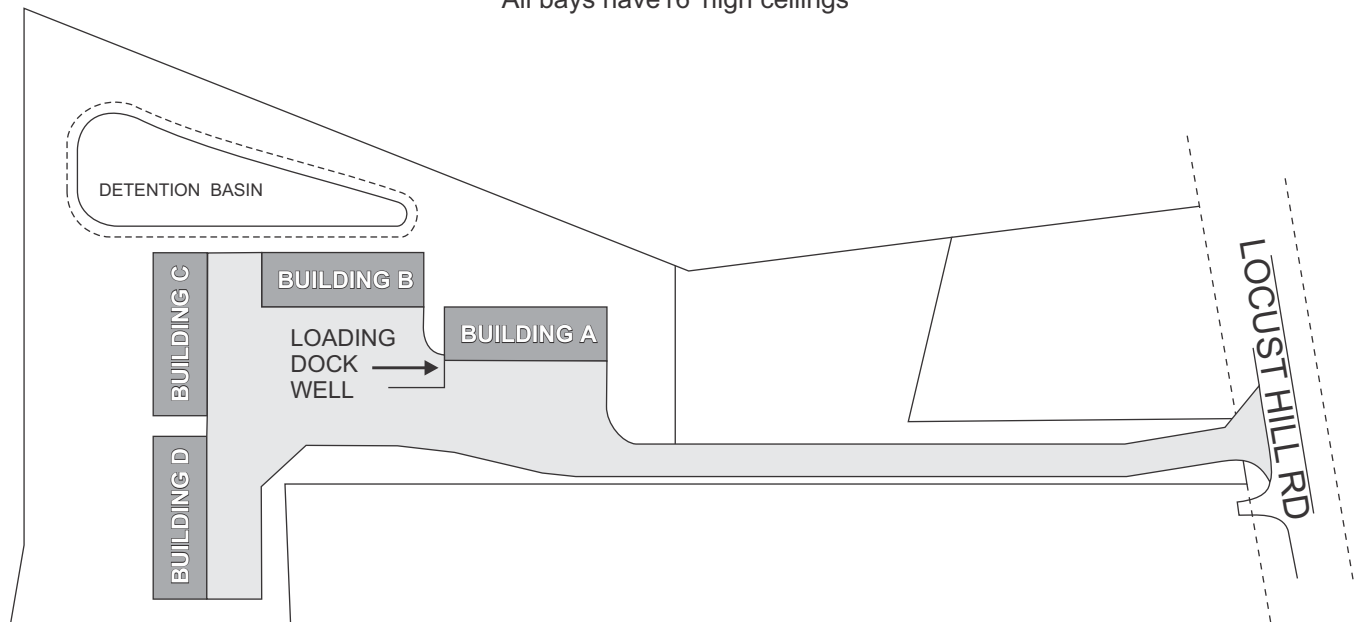





BUILD OUT OF AVAILABLE  
SPACE MAY DIFFER SLIGHTLY  
FROM PICTURES SHOWN

